

HUNTERS[®]

HERE TO GET *you* THERE



The Avenue

Worcester Park, KT4 7EQ

Asking Price £270,000



A well presented first floor apartment located in Mowat Court on the sought after road The Avenue in Worcester Park. The property benefits from generous living space with ample storage as well as allocated private parking. Excellent Transport links and Close to local amenities. Viewings are Highly recommended as the property comes with no chain.



Bedroom 11'11" x 8'6" (3.64m x 2.6m)
Bathroom 7'6" x 5'1" (2.31m x 1.56)
Living Room 14'1" x 11'1" (4.30m x 3.38m)
Kitchen 10'7" x 7'8" (3.25m x 2.35m)
Material Information WP
Tenure Type; Shre of Freehold
Leasehold Years remaining on lease; 980
Leasehold Annual Service Charge Amount £1200
Council Tax Banding; Band C

Area Map



Floor Plans

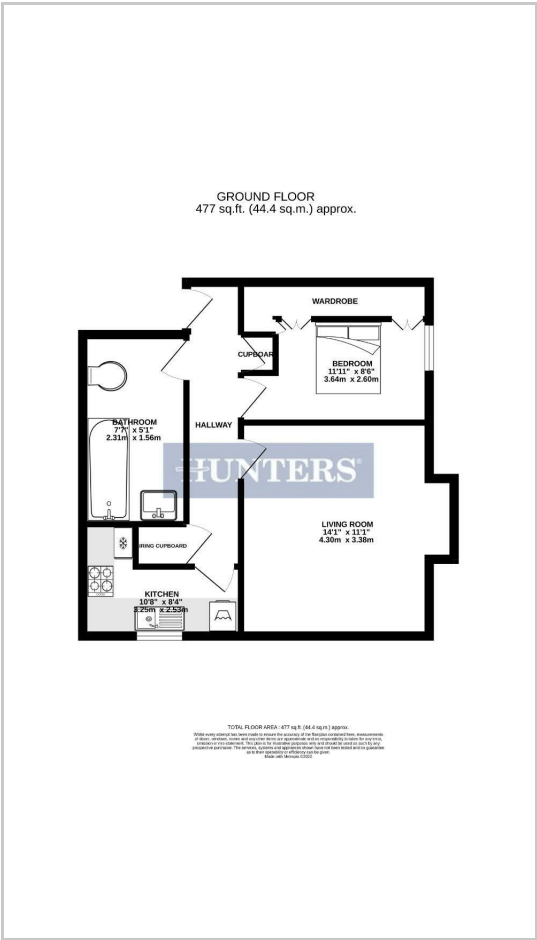

Energy Efficiency Graph

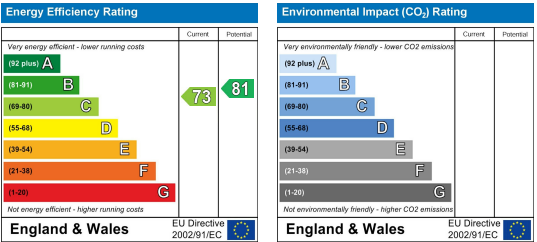

These particulars are intended to give a fair and reliable description of the property but no responsibility for any inaccuracy or error can be accepted and do not constitute an offer or contract. We have not tested any services or appliances (including central heating if fitted) referred to in these particulars and the purchasers are advised to satisfy themselves as to the working order and condition. If a property is unoccupied at any time there may be reconnection charges for any switched off/disconnected or drained services or appliances - All measurements are approximate. **THINKING OF SELLING?** If you are thinking of selling your home or just curious to discover the value of your property, Hunters would be pleased to provide free, no obligation sales and marketing advice. Even if your home is outside the area covered by our local offices we can arrange a Market Appraisal through our national network of Hunters estate agents.